

# DISCLAIMER

By using this product, you agree to the following terms:

## Warranty Conditions

Any modification, tampering, or unauthorized repair of this product will void the warranty. If you decide to alter, "customize," or otherwise mess with it, you're fully responsible for the outcome.

## Liability Waiver

We are not responsible for any damage, injury, or chaos caused by improper use, unauthorized modifications, or failure to follow the provided instructions. If you're about to do something questionable, stop and contact us first. Seriously.

## Intended Use

This product is designed for **normal use in overlanding\***. Using it for anything else is entirely at your own risk. We can't protect you from bad ideas or reckless experimentation.

## Safety First

Use this product responsibly and with the proper tools and equipment. If you're unsure about anything, don't improvise—reach out to us first. Don't blame us if you hurt yourself doing something we explicitly told you not to do.

**Got questions? Don't wing it. Contact us before doing anything outside the scope of normal use.**

## \*Normal Use in Overlanding

This roof rack is designed to withstand the typical demands of overlanding and off-road adventures, including:

**Vehicle Travel on Off-Road Terrain:** Gravel roads, dirt trails, and uneven surfaces within the vehicle's capabilities.

**Carrying Gear:** Securing cargo, such as camping equipment, storage boxes, and other accessories, within the stated weight limits.

**Exposure to Outdoor Conditions:** Reasonable exposure to weather, such as rain, wind, and sunlight, under normal outdoor use.

## What's Not Included in Normal Use:

**Exceeding Weight Capacity:** Overloading the rack beyond its stated maximum weight limit, whether stationary or in motion.

**Impacts or Collisions:** Damage resulting from accidents, impacts with low-hanging objects, or other collisions.

**Improper Attachment:** Failure to securely fasten cargo, which may result in damage to the rack, vehicle, or items being transported.

**Extreme Conditions:** Submersion in water, exposure to corrosive materials, or prolonged use in extreme weather beyond the product's specifications.

**Unauthorized Modifications:** Drilling, cutting, or altering the rack in any way that affects its structural integrity.

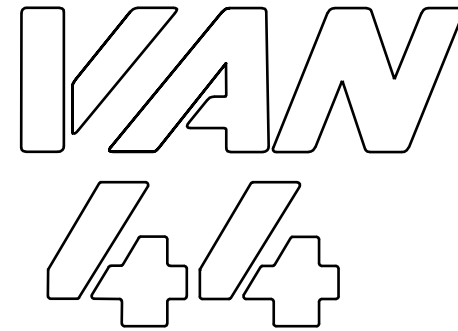

# ROOF RACK

## TOYOTA LC250 2024-PRESENT

## LEXUS GX550 2024-PRESENT

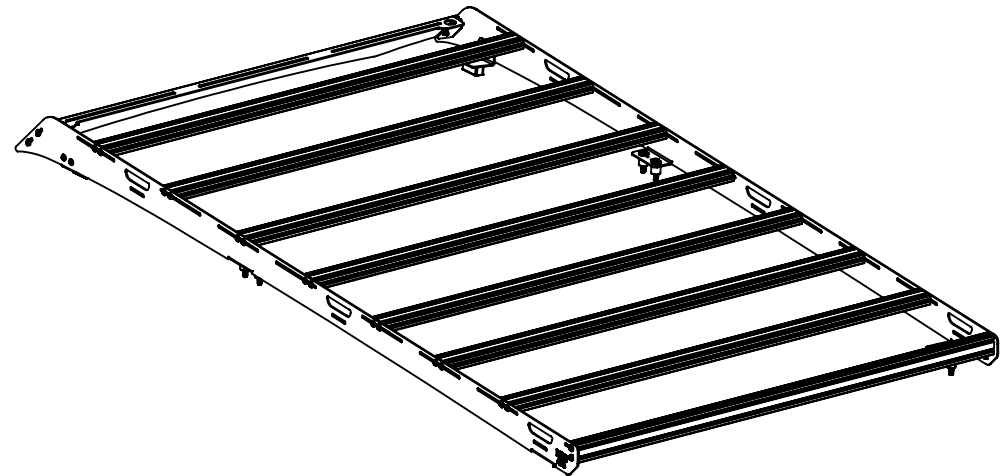

VAN44.COM  
SUPPORT@VAN44.COM  
INSTAGRAM: @VAN44\_OFFROAD

# INSTRUCTIONS

ITEM NO.	PART NUMBER	DESCRIPTION	QTY.
1	010405-0101	LH RAIL	1
2	010405-0102	RH RAIL	1
3	010405-0103	DEFLECTOR	1
4	010105-0105	LH SUPPORT	1
5	010105-0104	RH SUPPORT	1
6	990000-1102	1200MM CROSSBAR	8
7	990000-0506	FRONT SPACER	2
8	88000-0711A	L24MMxOD22MMxM10 SPACER	12
9	88000-0607S	M8 X 24 MM WASHER 18-8	12
10	88000-0202S	M8X 1.25 X 50MM HX HD SS	12
11	88000-0602B	M6 X 15MM WASHER BO SS	44
12	88000-0201B	M6X 1X 20MM TX BO SS	40
13	88000-0301S	M6 X 1 NYLOCK 18-8	4

#### STEP 1:

APPLY A BEAD OF SILICONE AROUND EACH M8 HOLE IN THE ROOF. ENSURE TO GET CLOSE TO THE PERIMETER OF THE HOLE. PLACE A 24MM SPACER ⑧ OVER EACH HOLE.

#### STEP 2:

INSTALL THE RAILS ①, ② USING M8 SCREWS ⑩ AND WASHERS ⑨, ONE SIDE AT A TIME. **DO NOT TIGHTEN THE BOLTS YET**

#### STEP 3:

INSTALL 8 CROSSBARS ⑥ USING HARDWARE ⑦, ⑬. **LEAVE BOLTS HAND TIGHT.** ONCE DESIRED POSITIONS ARE SET, TIGHTEN ALL CROSSBAR BOLTS.

#### STEP 4:

ALIGN THE SUPPORTS ④, ⑤ THE SLOT AT THE FRONT OF THE RAIL. MARK THE GUTTER WITH TAPE ON EITHER SIDE OF SUPPORT BRACKET (ADD AN EXTRA 1/4" TO EACH SIDE). REMOVE GUTTER STRIP AND CUT OUT MARKED SECTION. REINSTALL GUTTER STRIP

#### STEP 5:

INSTALL THE FRONT SPACER ⑦ INTO THE GUTTER. REMOVE THE ADHESIVE BACKING, THEN INSTALL THE SUPPORTS ④, ⑤ AS PER **DETAIL A**. LEAVE THE BOLTS LOOSE ENOUGH TO SLIDE THE BRACKET ALONG THE SLOT UNTIL IT MAKES CONTACT WITH THE ROOF, ONCE CONTACT WITH ADHESIVE HAS BEEN MADE, TIGHTEN M6 NUTS ⑬.

**TIGHTEN DOWN RAIL BOLTS ⑩.**

#### STEP 6:

INSTALL THE DEFLECTOR ③ USING REMAINING BOLTS, NUTS ⑦, ⑬. SLIDE DEFLECTOR UNTIL IT TOUCHES ROOF LINE, ENSURE EVEN CONTACT THROUGHOUT, THEN TIGHTEN 4 BOLTS.

## FOLLOWING THE CORRECT ORDER OF OPERATIONS IS CRITICAL

#### TOOLS/SUPPLIES NEEDED

- >> T30 TORX DRIVER
- >> 13MM WRENCH
- >> WEATHER RESISTANT BLACK SILICONE (EG. DAP DYNAFLEX ULTRA)
- >> ANTI SEIZE (**\*CRITICAL\* USE ON ALL BOLTS**)
- >> M8 X 1.25 TAP (FOR CHASING OEM THREADS)

#### PREPARATION NOTES:

- >> REMOVE ALL OEM ROOF RACK COMPONENTS AND HARDWARE
- >> THOROUGHLY CLEAN ALL SURFACES
- >> INSPECT THE (8) M8 OEM THREADS. ENSURE THEY ARE CLEAN AND FREE OF DEBRIS OR DAMAGE. CHASE THREADS WITH TAP IF NECESSARY
- >> RUBBER TRIM IS PROVIDED, BUT CLEAR PPF MAY BE INSTALLED UNDERNEATH THE DEFLECTOR AS AN EXTRA MEASURE TO PROTECT PAINT

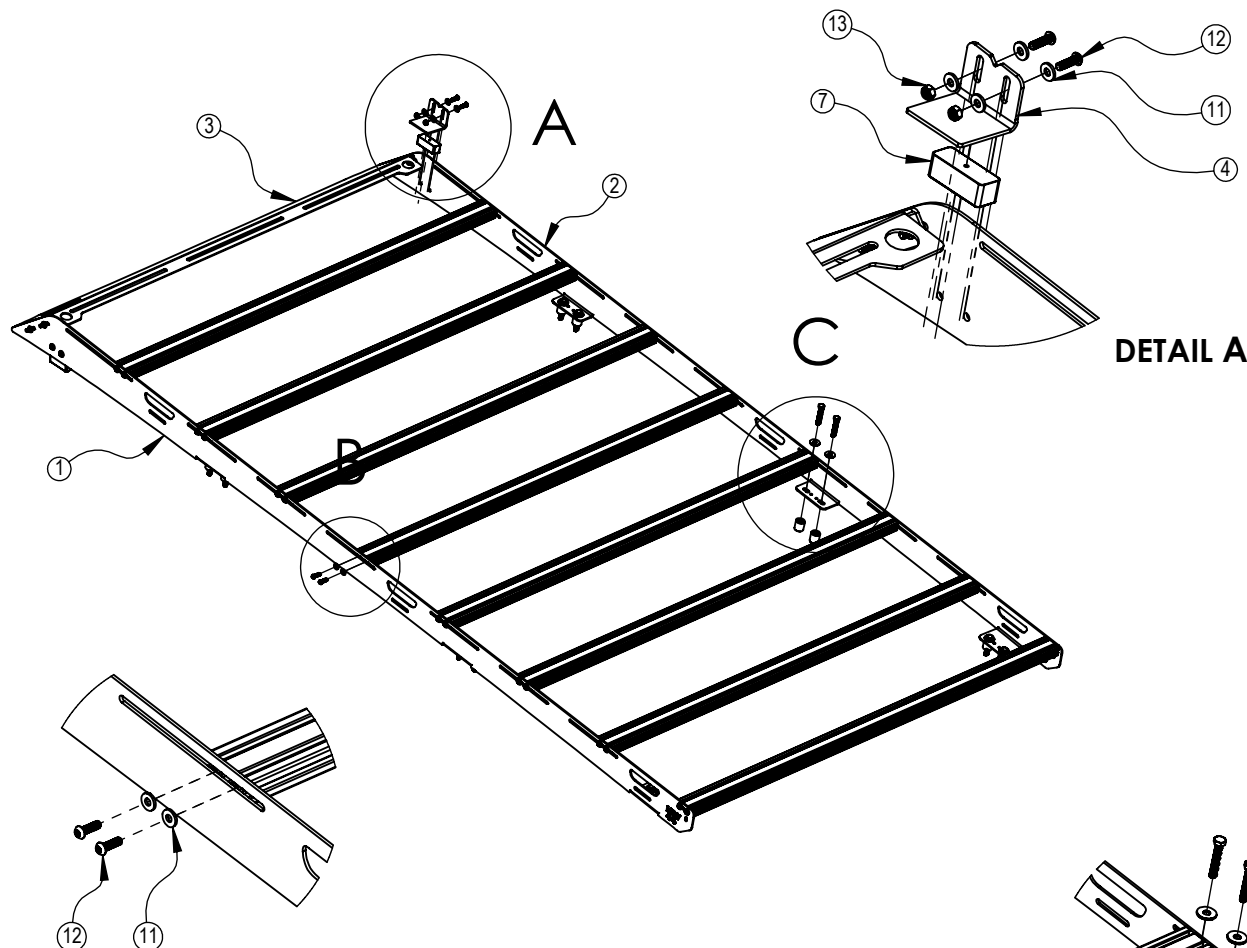
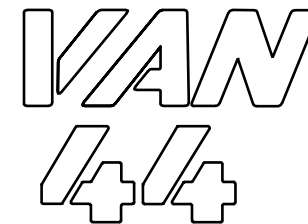

**DETAIL B**

**DETAIL A**

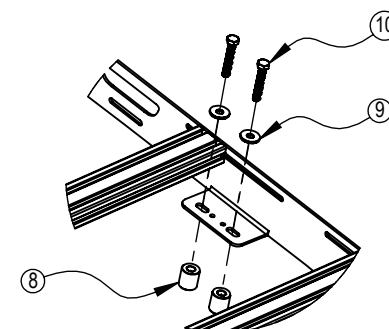

**DETAIL C**

## FOLLOWING THE CORRECT ORDER OF OPERATIONS IS CRITICAL